

**Attachment A**

**Legal Description**

**Legal Description**  
**952.89 Acre Tract**

A tract of land containing **952.89 acres, more or less**, situated within part of Surveys 111, 373 and 1654 and being out of a 1,109.48 acre tract recorded in Volume 3071, Pages 426 – 432, Official Public Records, Webb County, Texas, same being part of a larger 12,193.84 acre tract as described and depicted as Tract 2 on a Survey Plat by John E. Foster, R.P.L.S. on a Stipulation Conforming Surface Ownership, Agreed Boundary Line and Roadway Access instrument recorded in Volume 704, Page 827-852, R.P.R.W.C.T, Webb County, Texas. Said 952.89 acre tract being more particularly described as follows:

Commencing at an existing fence post being an exterior corner on the east boundary line of said aforementioned 12,193.84 acre tract, fence corner being the southeast corner of Survey 111 and an interior corner of Survey 1656; Thence, N 75°27'44" W, along the boundary line of said 12,193.84 acre tract and the common line of Survey 111 and Survey 1656, a distance of 1,350 feet along a fence to a ½ inch iron rod to be set being the southeast corner and **POINT OF BEGINNING** of this 952.89 acre tract;

Thence, N 75°27'44" W, continuing along a fence, the boundary line of said 12,193.84 acre tract and the common line of Survey 111 and Survey 1656, a distance of **3,000.01 feet** to an exterior corner of this tract;

Thence, N 14°24'42" E, a distance of **937.13 feet** to an interior corner of this tract;

Thence, N 75°35'18" W, a distance of **1,036.97 feet** to a ½ inch iron rod set for the southwest corner of this tract;

Thence, N 13°48'50" E, a distance of **4,380.61 feet** to a rock found in the ground, being the common corner of Surveys 111, 112, 373, 1654 and 2366 as described in field notes by E.J. Foster, Surveyor filed at the Texas General Land Office File Number 012687 for an interior corner of this tract;

Thence, N 76°11'10" W, along the extended north line of Survey 111, a distance of **1,422.10 feet** to a ½ inch iron rod to be set for an interior corner of this tract;

Thence, the following courses:

N 14°20'05" E, a distance of **233.87 feet** to a ½ inch iron rod to be set for a point of deflection to the left;

N 09°15'22" E, a distance of **2,689.04 feet** to a ½ inch iron rod to be set for an exterior corner of this tract;

S 80°34'28" E, a distance of **1,200 feet** to a ½ inch iron rod to be set for an interior corner of this tract;

N 09°25'32" E, a distance of **1,000 feet** to a ½ inch iron rod to be set for the northwest corner of this tract;

S 80°34'28" E, parallel to the south approximately 1,350 feet from northeast line of said aforementioned 12,193.84 tract being the boundary fence line and the north line Survey 373, a distance of **4,300 feet** to a ½ inch iron rod to be set for the northeast corner of this tract;

S 09°15'22" W, parallel to the west approximately 1,350 feet from the east boundary line of said aforementioned 12,193.84 acre tract and the common line of Survey 373 and Survey 374, a distance of **3,916.82 feet** for a point of deflection to the right;

Thence, S 14°20'05" W, same parallel to the west approximately 1,350 feet from the east boundary line said aforementioned 12,193.84 acre tract and the common line of Survey 373 and Survey 374, a distance of **70.54 feet** to a ½ inch iron rod to be set on the common line of Survey 373 and Survey 2366. Said ½ inch iron rod to be set bears N 81°11'10" W, a distance of 1,357.03 feet from a found 2 inch pipe found;

Thence, N 81°11'10" W, along the common line of Survey 373 and Survey 2366, pass a ½ inch iron rod found with plastic cap marked RPLS 5197 at a distance of 3,947.35 feet, continuing same course a **total distance of 4,099.92 feet** to a rock found in the ground, being the common corner of Surveys 111, 112, 373, 1654 and 2366 as described field notes by E. J. Foster, Surveyor filed at the Texas General Land Office File Number 012687 for and interior corner of this tract;

Thence S 76°11'10" E, along the common line of Survey 2366 and Survey 111, pass a ½ inch iron rod found with plastic cap marked RPLS 5197 at a distance of 152.27 feet, continuing same course a **total distance of 4,081.06 feet** to a ½ inch iron rod to be set which bears N 76°11'10" W, a distance of 1,350.26 feet from a ½ inch iron found with plastic cap marked RPLS 5197;

Thence, S 14°20'05" W, parallel approximately 1,350 feet from the east line of said 12,193.84 acre tract and the common line of Surveys 2366, Survey 111 and Survey 1657, a distance of **1,367.84 feet** to a set ½ inch iron rod for a point of deflection to the right;

Thence, S 14°24'42" W, parallel approximately 1,350 feet from the east line of said aforementioned 12,193.84 acre tract and common line of Survey 111 and Surveys 1656 and 1657, a distance of **3,998.85 feet** to the **POINT OF BEGINNING** of this **952.89 acre tract of land, more or less.**

**Basis of Bearing: Boundary Data on State Plane NAD 83 4206 Texas South**

**NOTE:**

**This survey was done without the benefit of a Title Company Research. There may be Easements of Record not shown on this Survey of which Surveyor is unaware of and as such assumes no liability herein.**

**STATE OF TEXAS  
COUNTY OF WEBB**

I, Gilbert L. Cade III, a Registered Professional Land Surveyor, do hereby certify that the foregoing legal description was prepared from Maps, Deeds and Other Documents of record made available and is correct to my best knowledge and was prepared from an actual survey made on the ground under my direction.



GILBERT L. CADE III, R.P.L.S. #5060

06/09/2014  
DATE

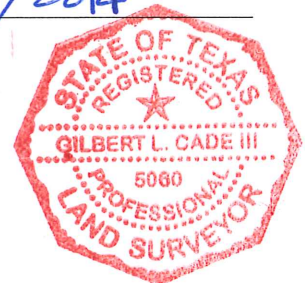

**Attachment B**

**Certificate of Formation**

Secretary of State  
P.O. Box 13697  
Austin, TX 78711-3697  
FAX: 512/463-5709

Filing Fee: \$300



**Certificate of Formation  
Limited Liability Company**

Filed in the Office of the  
Secretary of State of Texas  
Filing #: 801306787 08/17/2010  
Document #: 321481860002  
Image Generated Electronically  
for Web Filing

**Article 1 - Entity Name and Type**

The filing entity being formed is a limited liability company. The name of the entity is:

**Rancho Viejo Waste Management, LLC**

**Article 2 - Registered Agent and Registered Office**

☐ A. The initial registered agent is an organization (cannot be company named above) by the name of:

OR

☒ B. The initial registered agent is an individual resident of the state whose name is set forth below:

Name:

**Linda Cristina Alexander**

C. The business address of the registered agent and the registered office address is:

Street Address:

**1116 Calle del Norte Laredo TX 78041**

**Consent of Registered Agent**

☐ A. A copy of the consent of registered agent is attached.

OR

☒ B. The consent of the registered agent is maintained by the entity.

**Article 3 - Governing Authority**

☒ A. The limited liability company is to be managed by managers.

OR

☐ B. The limited liability company will not have managers. Management of the company is reserved to the members.

The names and addresses of the governing persons are set forth below:

Manager 1: **Guillermo D Benavides**

Title: **Manager**

Address: **1533 Eagle Court Laredo TX, USA 78045**

Manager 2: **Linda Cristina Alexander**

Title: **Manager**

Address: **916 Calle del Norte Laredo TX, USA 78041**

Manager 3: **Carlos Y Benavides III**

Title: **Manager**

Address: **2810 East Kearney Laredo TX, USA 78041**

**Article 4 - Purpose**

The purpose for which the company is organized is for the transaction of any and all lawful business for which limited liability companies may be organized under the Texas Business Organizations Code.

[The attached addendum, if any, is incorporated herein by reference.]

**Organizer**

The name and address of the organizer are set forth below.

**Carlos Y. Benavides, III      2810 East Kearney, Laredo, TX 78041**

**Effectiveness of Filing**

☒ A. This document becomes effective when the document is filed by the secretary of state.

**OR**

☐ B. This document becomes effective at a later date, which is not more than ninety (90) days from the date of its signing. The delayed effective date is:

**Execution**

The undersigned affirms that the person designated as registered agent has consented to the appointment. The undersigned signs this document subject to the penalties imposed by law for the submission of a materially false or fraudulent instrument and certifies under penalty of perjury that the undersigned is authorized under the provisions of law governing the entity to execute the filing instrument.

**Carlos Y. Benavides, III**

Signature of Organizer

**FILING OFFICE COPY**

**Form 503**  
**(Revised 09/09)**

Return in duplicate to:  
Secretary of State  
P.O. Box 13697  
Austin, TX 78711-3697  
512 463-5555  
FAX: 512 463-5709  
Filing Fee: \$25



### Assumed Name Certificate

This space reserved for office use.

**FILED**  
In the Office of the  
Secretary of State of Texas

JAN 05 2011

**Corporations Section**

### Assumed Name

1. The assumed name under which the business or professional service is, or is to be, conducted or rendered is: Pescadito Environmental Resource Center

### Entity Information

2. The legal name of the entity filing the assumed name is:

Rancho Viejo Waste Management, LLC

*State the name of the entity as currently shown in the records of the secretary of state or on its organizational documents, if not filed with the secretary of state.*

3. The entity filing the assumed name is a: (Select the appropriate entity type below.)

- |   |   |
|---|---|
| <input type="checkbox"/> For-profit Corporation   | <input checked="" type="checkbox"/> Limited Liability Company |
| <input type="checkbox"/> Nonprofit Corporation    | <input type="checkbox"/> Limited Partnership                  |
| <input type="checkbox"/> Professional Corporation | <input type="checkbox"/> Limited Liability Partnership        |
| <input type="checkbox"/> Professional Association | <input type="checkbox"/> Cooperative Association              |
| <input type="checkbox"/> Other                    |   |

*Specify type of entity. For example, foreign real estate investment trust, state bank, insurance company, etc.*

4. The file number, if any, issued to the entity by the secretary of state is: 801306787

5. The state, country, or other jurisdiction of formation of the entity is: Texas

6. The registered office or similar office address of the entity in its jurisdiction of formation is:

1116 Calle Del Norte

*Street Address*

Laredo

*City*

TX

*State*

USA

*Country*

78041

*Zip or Postal Code*

7. The entity's principal office address in Texas is: (See instructions.)

1116 Calle Del Norte

*Street Address*

Laredo

*City*

TX

*State*

78041

*Zip or Postal Code*

8. The entity is not organized under the laws of Texas and is not required by law to maintain a registered agent and registered office in Texas. Its office address outside the state is:

1116 Calle Del Norte  
Laredo  
TX  
78041

*Street Address*

*City*

*State*

*Zip or Postal Code*

### Period of Duration

☒ 9a. The period during which the assumed name will be used is 10 years from the date of filing with the secretary of state.

OR

☐ 9b. The period during which the assumed name will be used is \_\_\_\_\_ years from the date of filing with the secretary of state (not to exceed 10 years).

OR

☐ 9c. The assumed name will be used until \_\_\_\_\_ (not to exceed 10 years).  
*mm/dd/yyyy*

### County or Counties in which Assumed Name Used

10. The county or counties where business or professional services are being or are to be conducted or rendered under the assumed name are:

☒ All counties

☐ All counties with the exception of the following counties: \_\_\_\_\_

☐ Only the following counties: \_\_\_\_\_

### Execution

The undersigned signs this document subject to the penalties imposed by law for the submission of a materially false or fraudulent instrument and also certifies that the person is authorized to sign on behalf of the identified entity. If the undersigned is acting in the capacity of an attorney in fact for the entity, the undersigned certifies that the entity has duly authorized the undersigned in writing to execute this document.

Date: 12/16/10

*L. Cristina B. Alexander*

Signature of a person authorized by law to sign on behalf of the identified entity (see instructions)



**Attachment C**

**Payment Demonstration**



505 East Huntland Drive  
Suite 250  
Austin, TX 78752

512.329.6080 PHONE  
512.329.8750 FAX

[www.TRCsolutions.com](http://www.TRCsolutions.com)

March 28, 2011

Texas Commission on Environmental Quality  
Financial Administration Division  
Revenue Section/Cashier's Office, MC-214  
P.O. Box 13088  
Austin, Texas 78711-3088

**Reference: Fee Payment for MSW Permit Application  
Proposed Pescadito Environmental Resource Center  
Rancho Viejo Waste Management, LLC – MSW Permit No. (TBD)  
Laredo, Webb County, Texas**

Dear Cashier:

Enclosed is TRC's check No. 726221 payable to the Texas Commission on Environmental Quality (TCEQ) and issued in the amount of \$150.00. This payment is the application fee for the Municipal Solid Waste (MSW) Permit Application referenced above.

Please contact the undersigned if you have any questions.

Very truly yours,

A handwritten signature in black ink, reading 'James F. Neyens', written in a cursive style.

James F. Neyens, P.E.  
TBPE Firm No. F-3775

cc: TCEQ MSW Permits Section



21 Griffin Road North  
Windsor, CT 06095

Technically Complete, March 11, 2016

WACHOVIA BANK, N.A.  
Wilmington, DE  
62-22/311

CHECK DATE  
April 6, 2011

726221

PAY

One Hundred Fifty and 00/100 Dollars

AMOUNT

\$150.00

TO

Texas Commission On Environmental Quality (TCEQ)  
Cashier's Office  
P.O. Box 13088, MC-214  
Austin TX 78711-3088

By

VOID AFTER 90 DAYS

AUTHORIZED SIGNATURE

Security Check features  
included.  
Details on back

⑈ 7 2 6 2 2 1 ⑈ ⑆ 0 3 1 1 0 0 2 2 5 ⑆ 2 0 7 9 9 5 0 0 9 1 5 3 8 ⑈

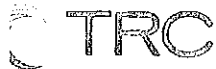

21 Griffin Road North  
Windsor, CT 06095

EMILY BUSINESS FORMS 800.392.6018 VISION

726221

Invoice Number	Date	Voucher	Amount	Discounts	Previous Pay	Net Amount
MSW PERMIT APP FEE	3/28/11	007753317176	150.00	0.00	0.00	150.00
Texas Commission On Environmental Quality (TCEQ) 3BANK 15 041426		Totals	150.00	0.00	0.00	150.00