

**Part III
Attachment III-G
Appendix III-G.1**

LANDFILL GAS MANAGEMENT PLAN FIGURES

**Pescadito Environmental Resource Center
MSW No. 2374
Webb County, Texas**

PESCADITO
ENVIRONMENTAL RESOURCE CENTER

**Initial Submittal March 2015
Revised September 2015**

**Prepared for:
Rancho Viejo Waste Management, LLC
1116 Calle del Norte
Laredo, TX 78041**

**Prepared by:
CB&I Environmental and
Infrastructure, Inc.**



**12005 Ford Rd, Suite 600
Dallas, TX 75234**

9-18-2015

Michael W. Oden

This document is released for the purpose of permitting only under the authority of Michael W. Oden, P.E. #67165. It is not to be used for bidding or construction. Texas Registered Engineering Firm F-5650.

The image shows a circular professional engineer seal for Michael W. Oden, State of Texas, registration number 67165. The seal includes a star in the center and the text "STATE OF TEXAS" and "REGISTERED PROFESSIONAL ENGINEER". A handwritten signature "Michael W. Oden" is written across the bottom of the seal. Above the seal, the date "9-18-2015" is handwritten. Below the seal, a disclaimer states: "This document is released for the purpose of permitting only under the authority of Michael W. Oden, P.E. #67165. It is not to be used for bidding or construction. Texas Registered Engineering Firm F-5650."

Table of Contents

III-G.1-1 Landfill Gas Monitoring Plan.....	1
III-G.1-2 Typical Gas Probe and Utility Vent	2

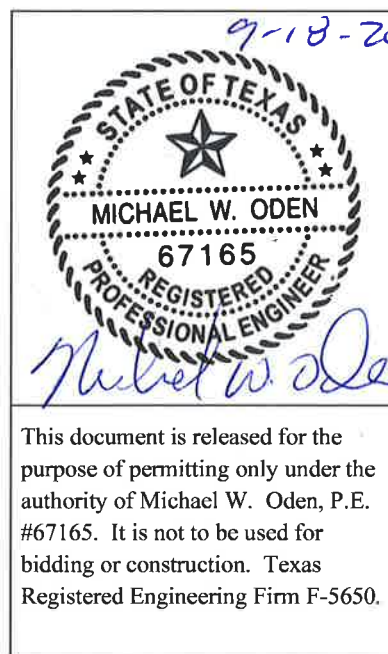

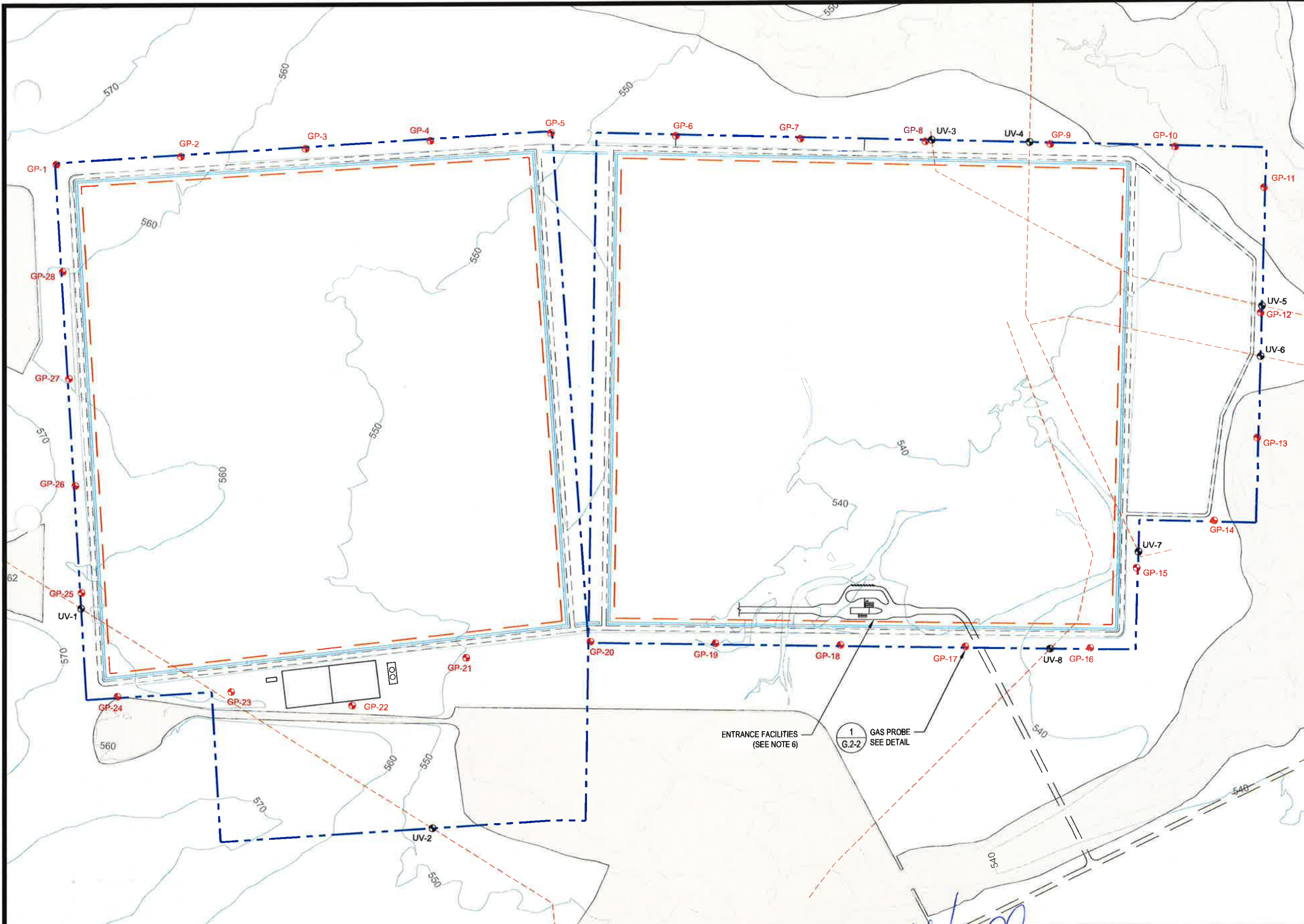

LEGEND

- PERMIT BOUNDARY
- WASTE UNIT BOUNDARY
- PERIMETER DITCH
- PERIMETER ACCESS ROAD
- PIPELINE EASEMENT CENTERLINE
- GP-1 GAS PROBE LOCATION
- UV-1 UTILITY VENT LOCATION
- CLOMR 100-YEAR FLOODPLAIN

NOTES

1. EXISTING CONTOURS DEVELOPED FROM SITE AERIAL TOPOGRAPHIC SURVEY BY DALLAS AERIAL SURVEYS ON FEBRUARY 15, 2010.
2. FOR CLARITY, NOT ALL SITE FEATURES MAY BE SHOWN.
3. THE NEED FOR FLEXIBILITY TO ACCOMMODATE ADJUSTMENTS AND MODIFICATIONS IS ANTICIPATED CONSIDERING THE SIZE, COMPLEXITY, AND LIFE OF THE PROJECT.
4. FOR UTILITY VENT SEE DETAIL 2 OF DRAWING G.2-2. UTILITY VENTS TO BE INSTALLED AT PROPERTY LINE WHEN WASTE IS WITHIN 1,000 FEET, UNLESS PIPELINE HAS BEEN ABANDONED AND REMOVED.
5. GAS PROBES WILL BE INSTALLED AS CELLS ARE CONSTRUCTED SO THAT A PROBE EXISTS AT LEAST 1000 FEET FROM WASTE.
6. SCALE HOUSE TO HAVE PERMANENT MONITOR.

REV. NO.	DATE	DESCRIPTION

CB&I Environmental & Infrastructure, Inc.
TBPE FIRM F-5650

CB&I Environmental and Infrastructure, Inc. has prepared this document for a specific project or purpose. All information contained within this document is copyright and remains intellectual property of CB&I Environmental and Infrastructure, Inc. This document may not be used or copied, in part or in whole, for any reason without expressed written consent by CB&I Environmental and Infrastructure, Inc.



THIS DOCUMENT IS RELEASED FOR THE PURPOSE OF PERMITTING UNDER THE AUTHORITY OF MICHAEL W. ODEN, P.E. 67165.
3-2-2015

**PESCADITO ENVIRONMENTAL RESOURCE CENTER
WEBB COUNTY, TEXAS
MSW 2374**

LANDFILL GAS MONITORING PLAN

PROJ. NO.:	148866	DATE:	MARCH 2015
DESIGNED BY:	-	DRAWING NO.:	III
DRAWN BY:	MTE		G.1-1
CHECKED BY:	RDS		1 OF 2 SHEETS
APPROVED BY:	MWO		

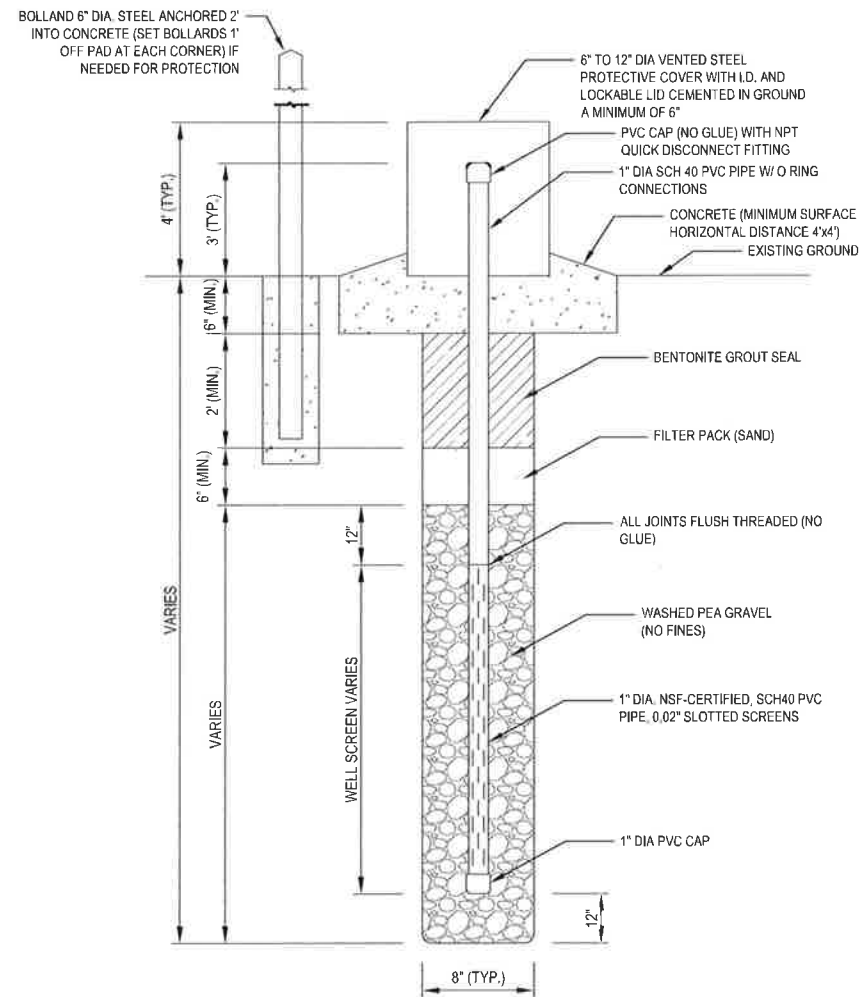

1
G.2-2

PROBE DETAIL
NOT TO SCALE

NOTES:

- FOR EACH PROBE LOCATION, FOUR PROTECTIVE BARRIER PIPES (BOLLARD) MAY BE USED IF NEEDED FOR PROTECTION. THE PROTECTIVE PIPES WILL BE 6" IN DIAMETER AND SET 2' INTO CONCRETE.
- CONSTRUCTION SPECIFICATIONS MAY VARY BASED ON FIELD DATA AND OBSERVATIONS DURING INSTALLATION OF PROBES.

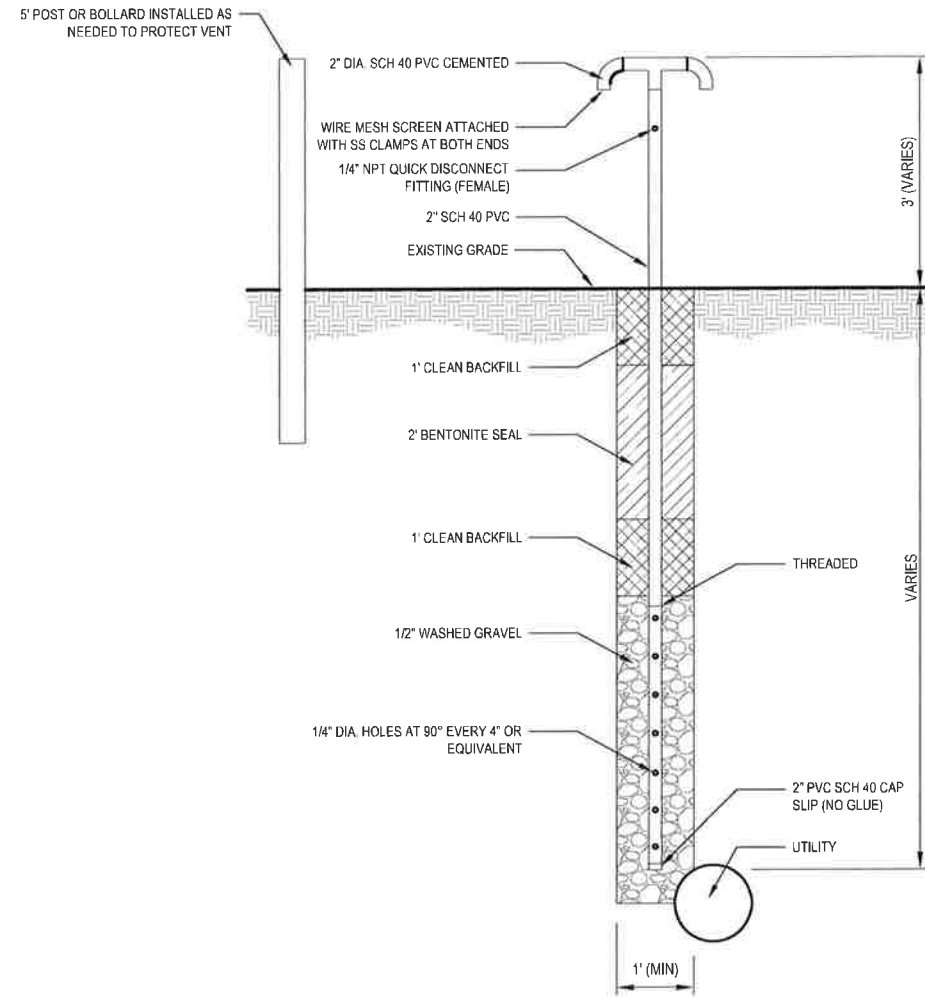

2
G.2-2

UTILITY VENT
NOT TO SCALE

NOTES:

- LOCATE UTILITY PRIOR TO INSTALLATION.
- MAKE SURE GRAVEL PACK IS IN CONTACT WITH UTILITY.
- OBTAIN APPROVAL FROM UTILITY/OWNER PRIOR TO INSTALLATION.

GAS PROBE AND UTILITY VENT SUMMARY TABLE

Name	Northing	Easting	Ground Surface Elevation (ft MSL)	Depth to Liner (ft)
GP-1	17099182.79	773929.40	567.17	109.17
GP-2	17098196.04	773767.14	562.01	104.65
GP-3	17097209.30	773604.87	556.65	100.66
GP-4	17096222.61	773442.24	553.36	98.73
GP-5	17095268.11	773286.09	550.78	98.84
GP-6	17094299.16	773037.50	548.85	101.13
GP-7	17093330.28	772788.08	547.49	102.75
GP-8	17092362.10	772539.66	545.38	103.61
GP-9	17091393.36	772291.60	542.95	104.16
GP-10	17090424.53	772042.41	539.95	101.95
GP-11	17089802.46	771563.46	535.98	97.98
GP-12	17090053.48	770595.48	537.19	98.66
GP-13	17090304.50	769627.49	533.20	84.00
GP-14	17090792.82	769061.52	536.03	96.39
GP-15	17091478.20	768831.38	537.66	97.76
GP-16	17091984.47	768293.13	537.94	97.94
GP-17	17092955.54	768531.90	542.05	99.95
GP-18	17093926.62	768770.66	541.26	96.76
GP-19	17094897.70	769009.43	540.00	93.11
GP-20	17095868.77	769248.20	543.89	93.93
GP-21	17096863.74	769346.88	549.18	96.24
GP-22	17097838.72	769179.56	558.01	103.19
GP-23	17098758.79	769504.46	557.76	100.97
GP-24	17099647.68	769668.70	561.02	103.02
GP-25	17099744.84	770543.72	560.85	102.85
GP-26	17099604.33	771390.13	567.17	109.17
GP-27	17099463.81	772236.55	559.13	101.13
GP-28	17099323.30	773082.97	559.95	101.95
UV-1	17098775.36	770420.96	561.07	-
UV-2	17097428.98	768078.20	548.94	-
UV-3	17092309.92	772538.52	545.27	-
UV-4	17091552.80	772343.96	543.42	-
UV-5	17090030.26	770645.16	537.37	-
UV-6	17090131.46	770254.93	536.00	-
UV-7	17091436.21	768954.59	537.61	-
UV-8	17092297.69	768359.84	538.94	-

REV. NO.	DATE	DESCRIPTION
1	9/2015	NOD 1



CB&I Environmental & Infrastructure, Inc.
TBPE FIRM F-5650

CB&I Environmental and Infrastructure, Inc. has prepared this document for a specific project or purpose. All information contained within this document is copyrighted and remains intellectual property of CB&I Environmental and Infrastructure, Inc. This document may not be used or copied, in part or in whole, for any reason without express written consent by CB&I Environmental and Infrastructure, Inc.

Michael W. Oden

 THIS DOCUMENT IS RELEASED FOR THE PURPOSE OF PERMITTING UNDER THE AUTHORITY OF MICHAEL W. ODEN, P.E. 67165.
 9-18-2015

**PESCADITO ENVIRONMENTAL RESOURCE CENTER
WEBB COUNTY, TEXAS
MSW 2374**

TYPICAL GAS PROBE AND UTILITY VENT

PROJ. NO.:	148866	DATE:	APRIL 2015
DESIGNED BY:	-	DRAWING NO.:	III
DRAWN BY:	MTE		G.1-2
CHECKED BY:	RDS		2 OF 2 SHEETS
APPROVED BY:	MWO		