

Changed Pages

Part III, Appendix III-B.1

General Facility Design Figures

**Part III
Attachment III-B
Appendix III-B.1**

GENERAL FACILITY DESIGN FIGURES

**Pescadito Environmental Resource Center
MSW No. 2374
Webb County, Texas**

PESCADITO
ENVIRONMENTAL RESOURCE CENTER

**Initial Submittal March 2015
Revised September 2015
Revised November 2015
Technically Complete March 11, 2016
Modified October 2016
Modified November 2016
Modified August 2017**

**Prepared for:
Rancho Viejo Waste Management, LLC
1116 Calle del Norte
Laredo, TX 78041**

**Prepared by:
APTIM Environmental &
Infrastructure, Inc.
(f/k/a CB&I Environmental &
Infrastructure, Inc.)**



**12005 Ford Rd, Suite 600
Dallas, TX 75234**

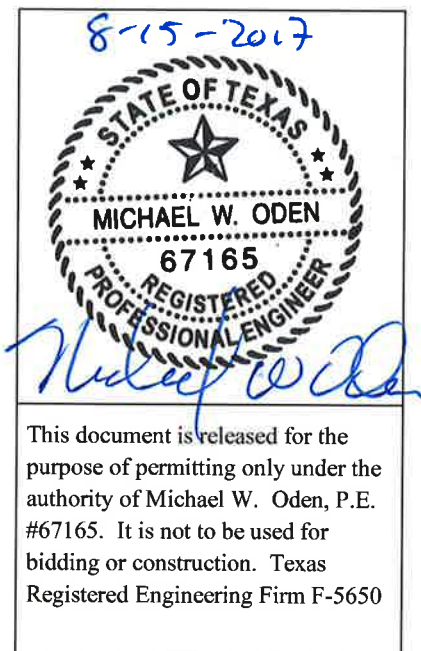
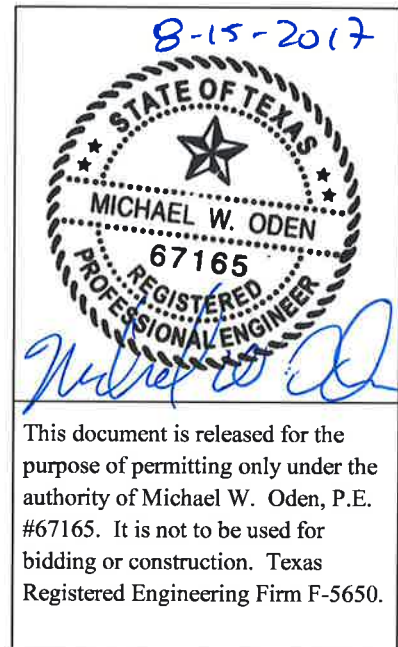
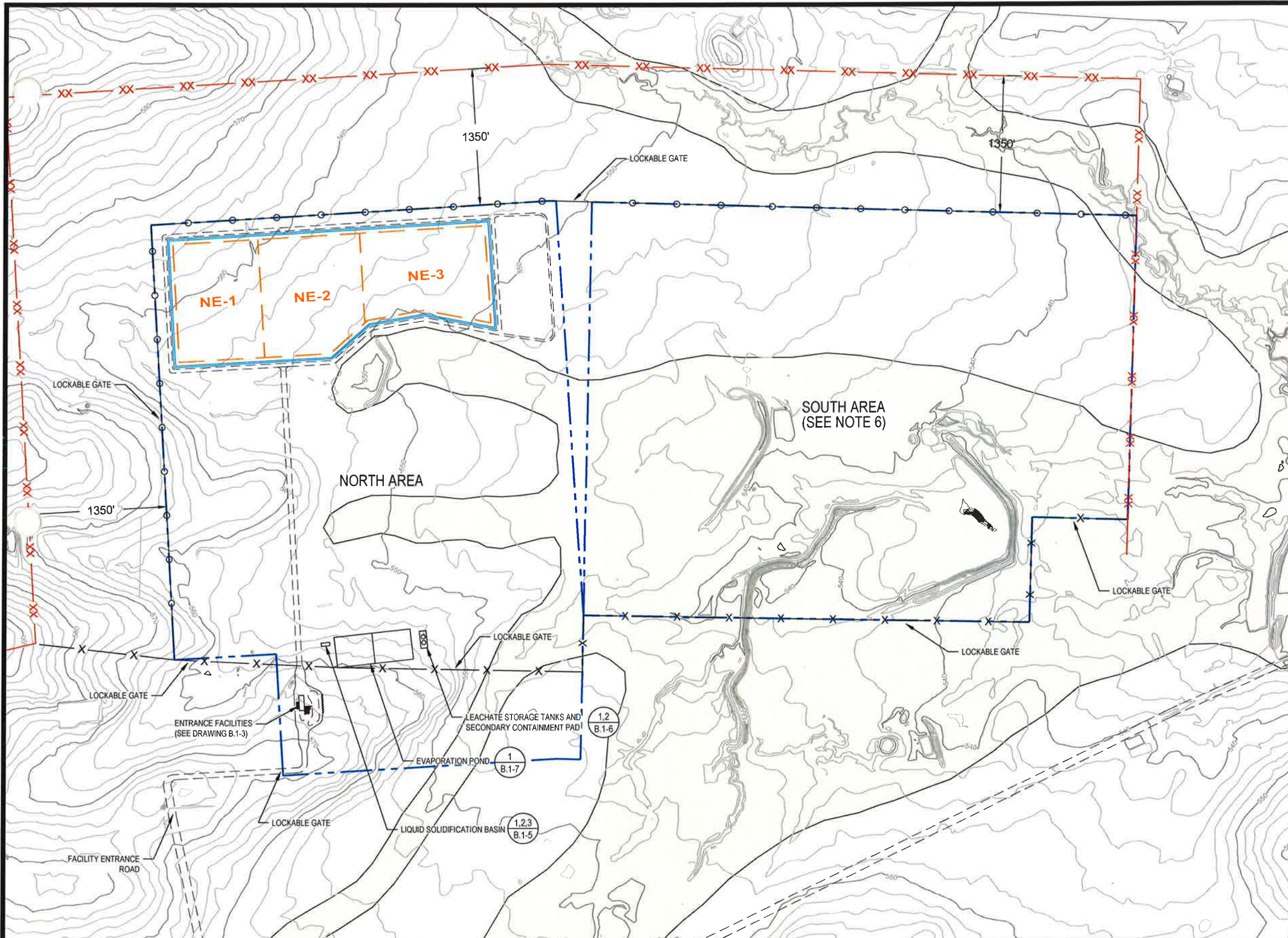

Table of Contents

III-B.1-1 Waste Flow Diagram	1
III-B.1-2 Waste Disposal, Processing and Storage Plan	2
III-B.1-3 Entrance Facilities	3
III-B.1-4 Convenience Center Details	4
III-B.1-5 Liquid Solidification Basin Plan and Details	5
III-B.1-6 Leachate Storage Details	6
III-B.1-7 Evaporation Pond Plan, Profiles and Details.....	7





LEGEND

- PERMIT BOUNDARY
- WASTE UNIT BOUNDARY
- PERIMETER ACCESS ROAD
- PERIMETER STORMWATER DITCH
- 100-YEAR FLOODPLAIN (PER FIRM DATED APRIL 2, 2008, SEE NOTE 5)
- XX EXISTING GAME FENCE
- X ACCESS CONTROL FENCE
- FUTURE FENCE (IF NEEDED)

NOTES

1. EXISTING CONTOURS DEVELOPED FROM SITE AERIAL TOPOGRAPHIC SURVEY BY DALLAS AERIAL SURVEYS ON FEBRUARY 15, 2010.
2. BOUNDARY AND IMPROVEMENT SURVEY DEVELOPED BY MEJIA ENGINEERING COMPANY ON AUGUST 15, 2011 AND JUNE 9, 2014.
3. FOR CLARITY, NOT ALL SITE FEATURES MAY BE SHOWN.
4. THE NEED FOR FLEXIBILITY TO ACCOMMODATE ADJUSTMENTS AND MODIFICATIONS IS ANTICIPATED CONSIDERING THE SIZE, COMPLEXITY, AND LIFE OF THE PROJECT.
5. 100-YEAR FLOODPLAIN FROM FLOOD INSURANCE RATE MAP FOR WEBB COUNTY, TEXAS, MAP NO. 48479C1275C, DATED APRIL 2, 2008. A CLOMR THAT WOULD REMOVE A LARGE AREA OF THE 100-YEAR FLOODPLAIN WITHIN THE PERMIT BOUNDARY WAS APPROVED BY FEMA ON NOVEMBER 21, 2014; HOWEVER, THE CLOMR IMPROVEMENTS HAVE NOT BEEN CONSTRUCTED.
6. FUTURE WASTE PROCESSING OR DISPOSAL AREA SUBJECT TO PERMIT MODIFICATION OR AMENDMENT.

REV. NO.	DATE	DESCRIPTION
2	06/2017	REVISED WASTE UNIT BOUNDARY AND ENTRANCE
1	10/2016	ADDED FENCE AND GATE LOCATIONS

APTIM Environmental & Infrastructure, Inc.
(f/k/a CB&I Environmental & Infrastructure, Inc.)
 TBPE FIRM F-5650

APTIM Environmental & Infrastructure, Inc. has prepared this document for a specific project or purpose. All information contained within this document is copyrighted and remains intellectual property of APTIM Environmental & Infrastructure, Inc. This document may not be used or copied, in part or in whole, for any reason without expressed written consent by APTIM Environmental & Infrastructure, Inc.

8-15-2017

THIS DOCUMENT IS RELEASED FOR THE PURPOSE OF PERMITTING UNDER THE AUTHORITY OF MICHAEL W. ODEN, P.E. 67165.

Michael W. Oden

**PESCADITO ENVIRONMENTAL RESOURCE CENTER
 WEBB COUNTY, TEXAS
 MSW 2374**

WASTE DISPOSAL, PROCESSING, AND STORAGE PLAN

PROJ. NO.:	148868	DATE:	AUGUST 2017
DESIGNED BY:	-	DRAWING NO.:	III
DRAWN BY:	MTE		B.1-2
CHECKED BY:	RDS		
APPROVED BY:	MWO		2 OF 6 SHEETS

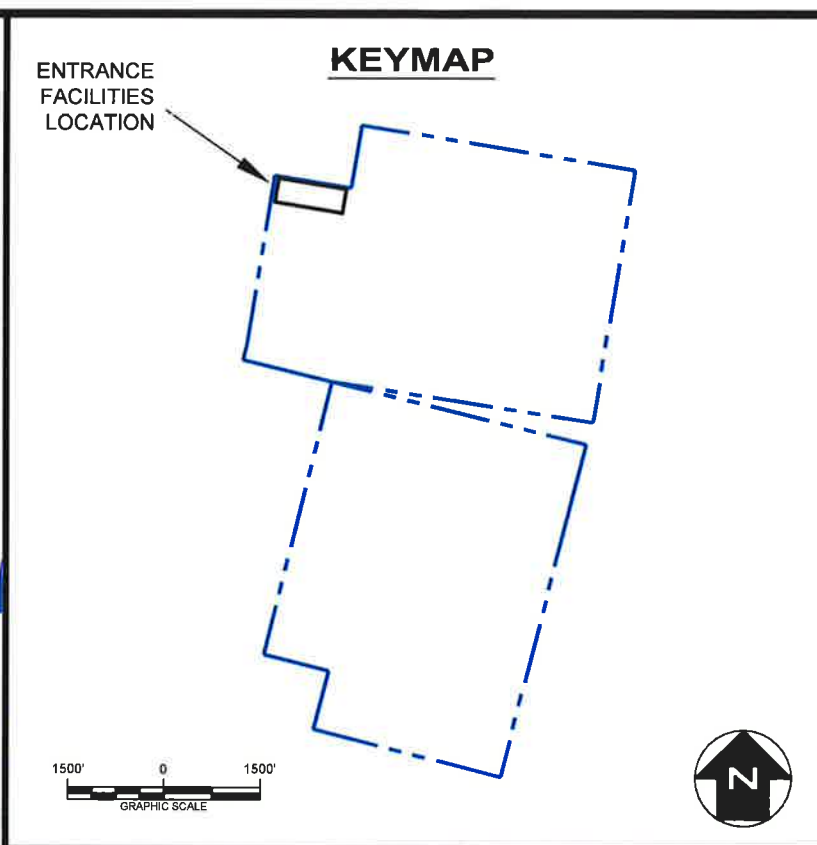
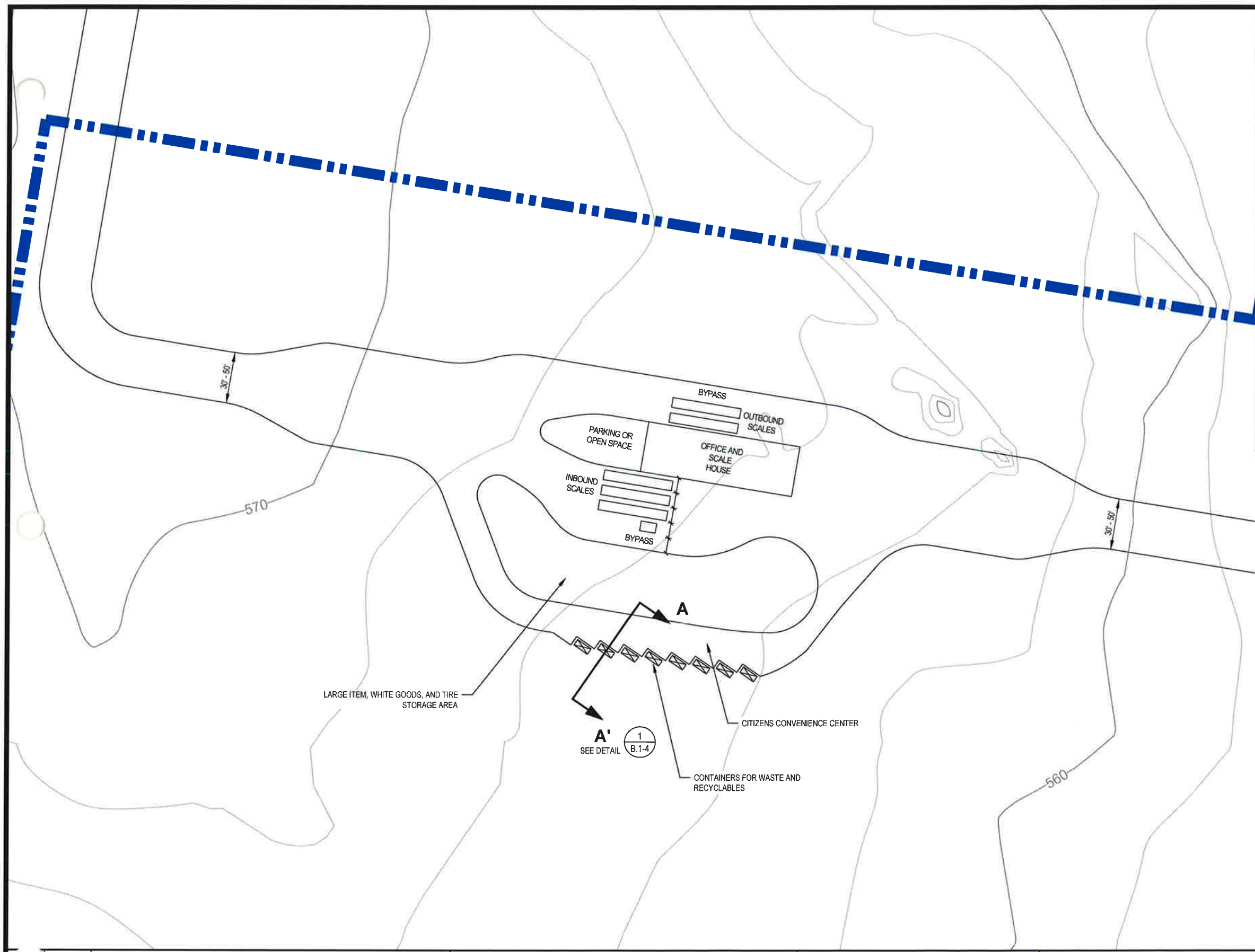

- NOTES**
1. EXISTING CONTOURS DEVELOPED FROM SITE AERIAL TOPOGRAPHIC SURVEY BY DALLAS AERIAL SURVEYS ON FEBRUARY 15, 2010.
 2. FOR CLARITY, NOT ALL SITE FEATURES MAY BE SHOWN.
 3. ACTUAL DIMENSIONS, NUMBER OF SCALES, AND NUMBER OF CONTAINERS MAY CHANGE DEPENDING ON AMOUNT OF MATERIAL RECEIVED.

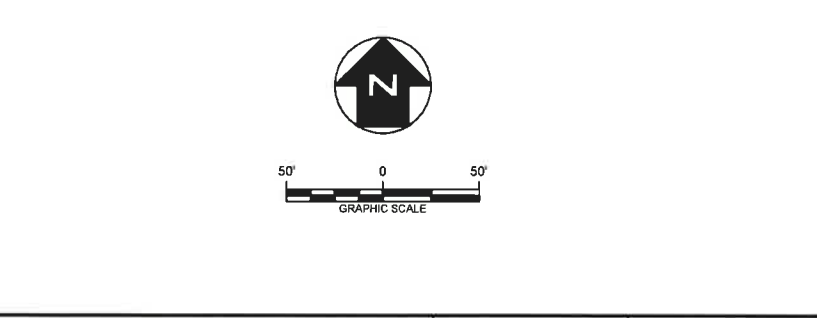

REV. NO.	DATE	DESCRIPTION
2	08/2017	REVISED ENTRANCE LOCATION
1	09/2015	NOD 1

APTIM Environmental & Infrastructure, Inc.
 (f/k/a CB&I Environmental & Infrastructure, Inc.)
 TBPE FIRM F-5650

APTIM Environmental & Infrastructure, Inc. has prepared this document for a specific project or purpose. All information contained within this document is copyrighted and remains intellectual property of APTIM Environmental & Infrastructure, Inc. This document may not be used or copied, in part or in whole, for any reason without expressed written consent by APTIM Environmental & Infrastructure, Inc.

8-15-2017

THIS DOCUMENT IS RELEASED FOR THE PURPOSE OF PERMITTING UNDER THE AUTHORITY OF MICHAEL W. ODEN, P.E. 67165.

PESCADITO ENVIRONMENTAL RESOURCE CENTER
WEBB COUNTY, TEXAS
MSW 2374

ENTRANCE FACILITIES PLAN

PROJ. NO.:	148868	DATE:	AUGUST 2017
DESIGNED BY:	-	DRAWING NO.:	III
DRAWN BY:	BMM		B.1-3
CHECKED BY:	RDS		
APPROVED BY:	MWO		3 OF 6 SHEETS

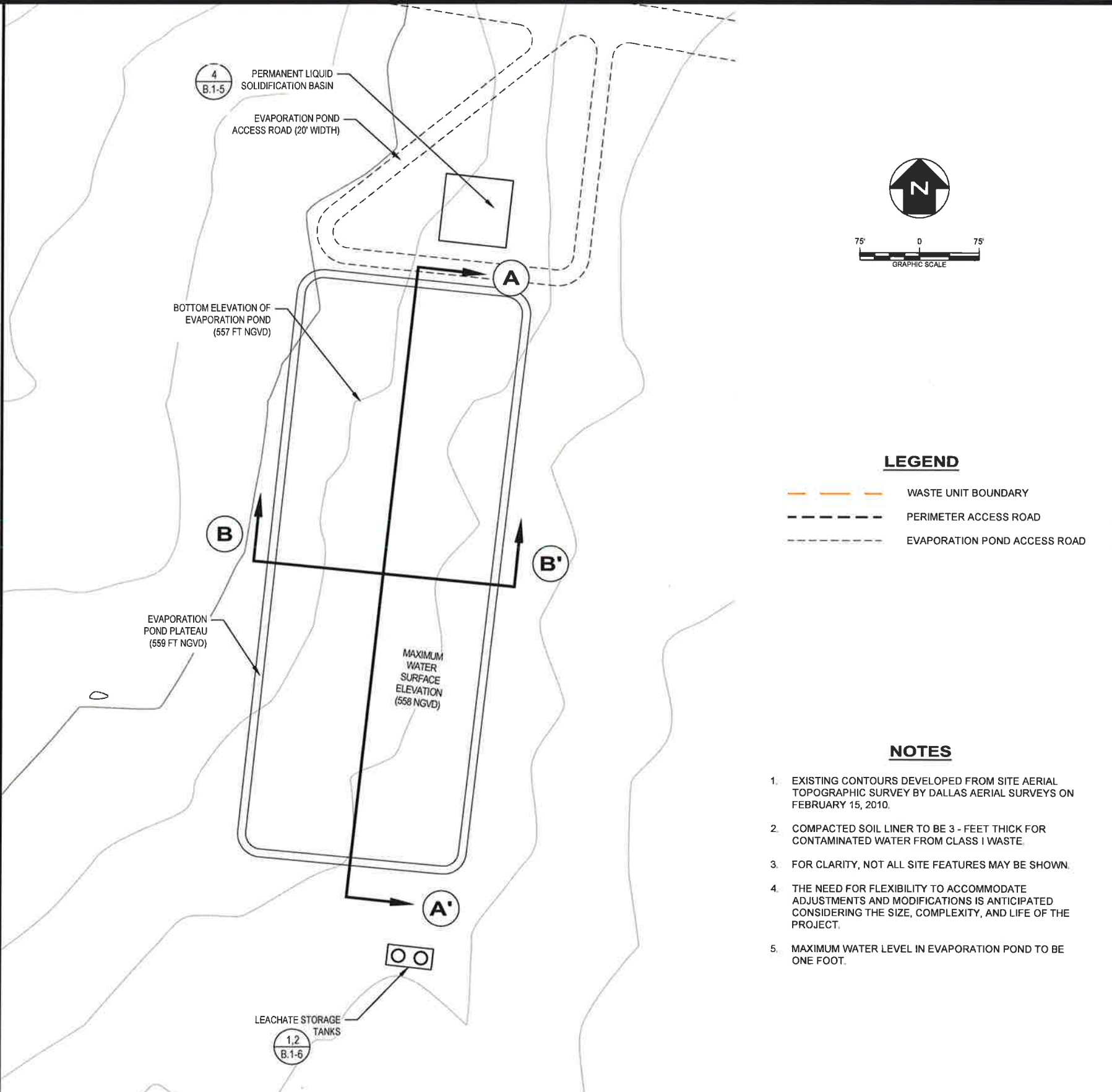
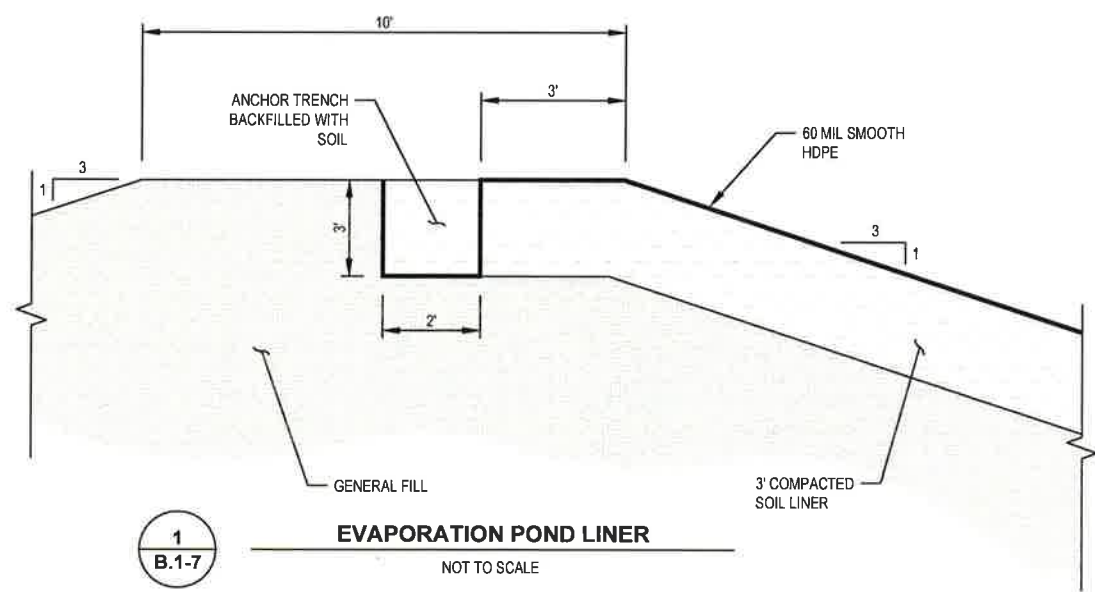
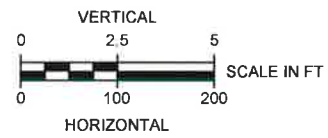
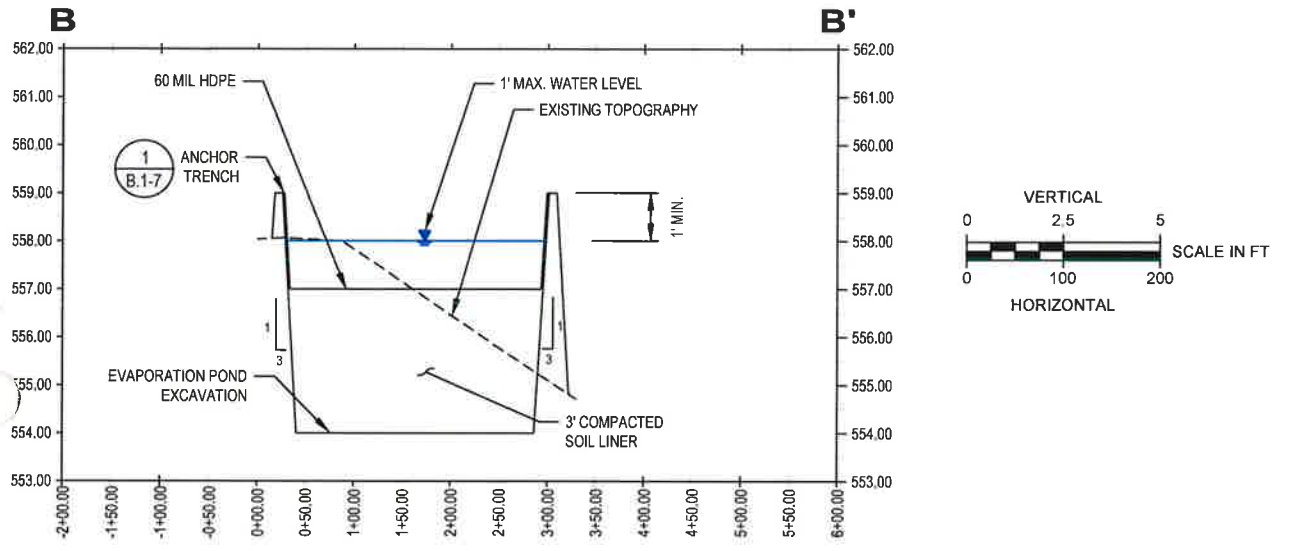
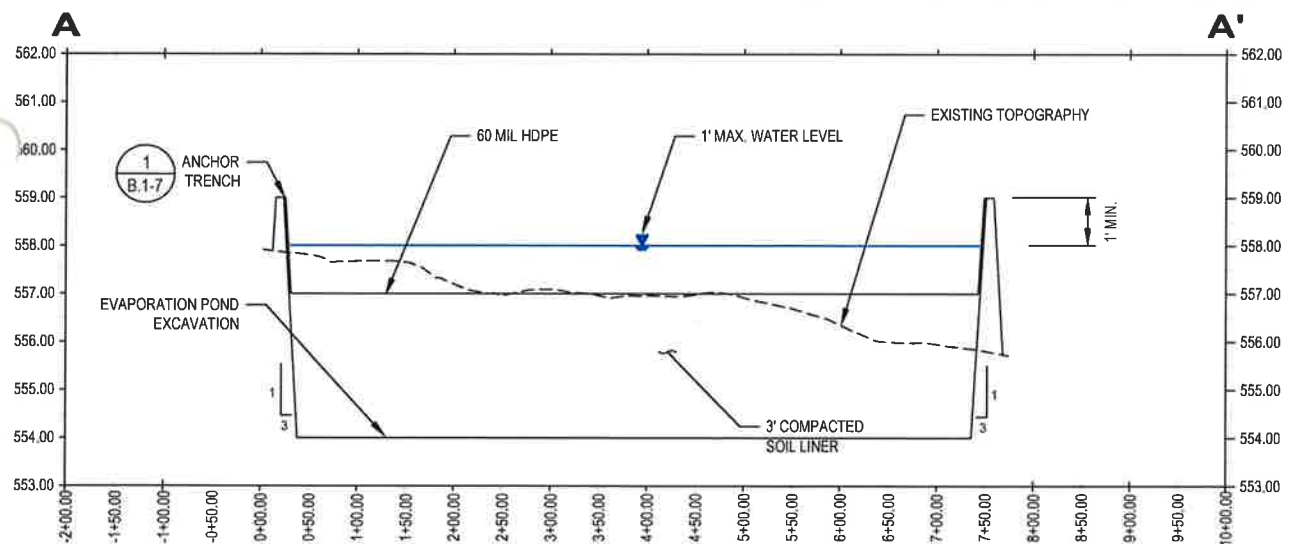

LEGEND

- WASTE UNIT BOUNDARY
- PERIMETER ACCESS ROAD
- EVAPORATION POND ACCESS ROAD

- NOTES**
1. EXISTING CONTOURS DEVELOPED FROM SITE AERIAL TOPOGRAPHIC SURVEY BY DALLAS AERIAL SURVEYS ON FEBRUARY 15, 2010.
 2. COMPACTED SOIL LINER TO BE 3 - FEET THICK FOR CONTAMINATED WATER FROM CLASS I WASTE.
 3. FOR CLARITY, NOT ALL SITE FEATURES MAY BE SHOWN.
 4. THE NEED FOR FLEXIBILITY TO ACCOMMODATE ADJUSTMENTS AND MODIFICATIONS IS ANTICIPATED CONSIDERING THE SIZE, COMPLEXITY, AND LIFE OF THE PROJECT.
 5. MAXIMUM WATER LEVEL IN EVAPORATION POND TO BE ONE FOOT.

REV. NO.	DATE	DESCRIPTION
2	08/2017	REVISED FLOODPLAIN AND WASTE UNIT BOUNDARY
1	09/2015	NOD 1

APTIM Environmental & Infrastructure, Inc.
(f/k/a CB&I Environmental & Infrastructure, Inc.)
 TYPE FIRM F-5650
 APTIM Environmental & Infrastructure, Inc. has prepared this document for a specific project or purpose. All information contained within this document is copyrighted and remains intellectual property of APTIM Environmental & Infrastructure, Inc. This document may not be used or copied, in part or in whole, for any reason without expressed written consent by APTIM Environmental & Infrastructure, Inc.

8-15-2017

THIS DOCUMENT IS RELEASED FOR THE PURPOSE OF PERMITTING UNDER THE AUTHORITY OF MICHAEL W. ODEN, P.E. 67165.

**PESCADITO ENVIRONMENTAL RESOURCE CENTER
 WEBB COUNTY, TEXAS
 MSW 2374**

EVAPORATION POND PLAN, PROFILES, AND DETAILS

PROJ. NO.:	148866	DATE:	AUGUST 2017
DESIGNED BY:	-	DRAWING NO.:	III
DRAWN BY:	MTE		B.1-7
CHECKED BY:	RDS		
APPROVED BY:	MWO		7 OF 7 SHEETS