

Part III

Attachment III-F

Appendix III-F.1

**No Redline Version for Title Page or TOC - Not previously
provided**

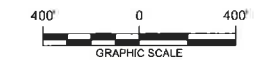
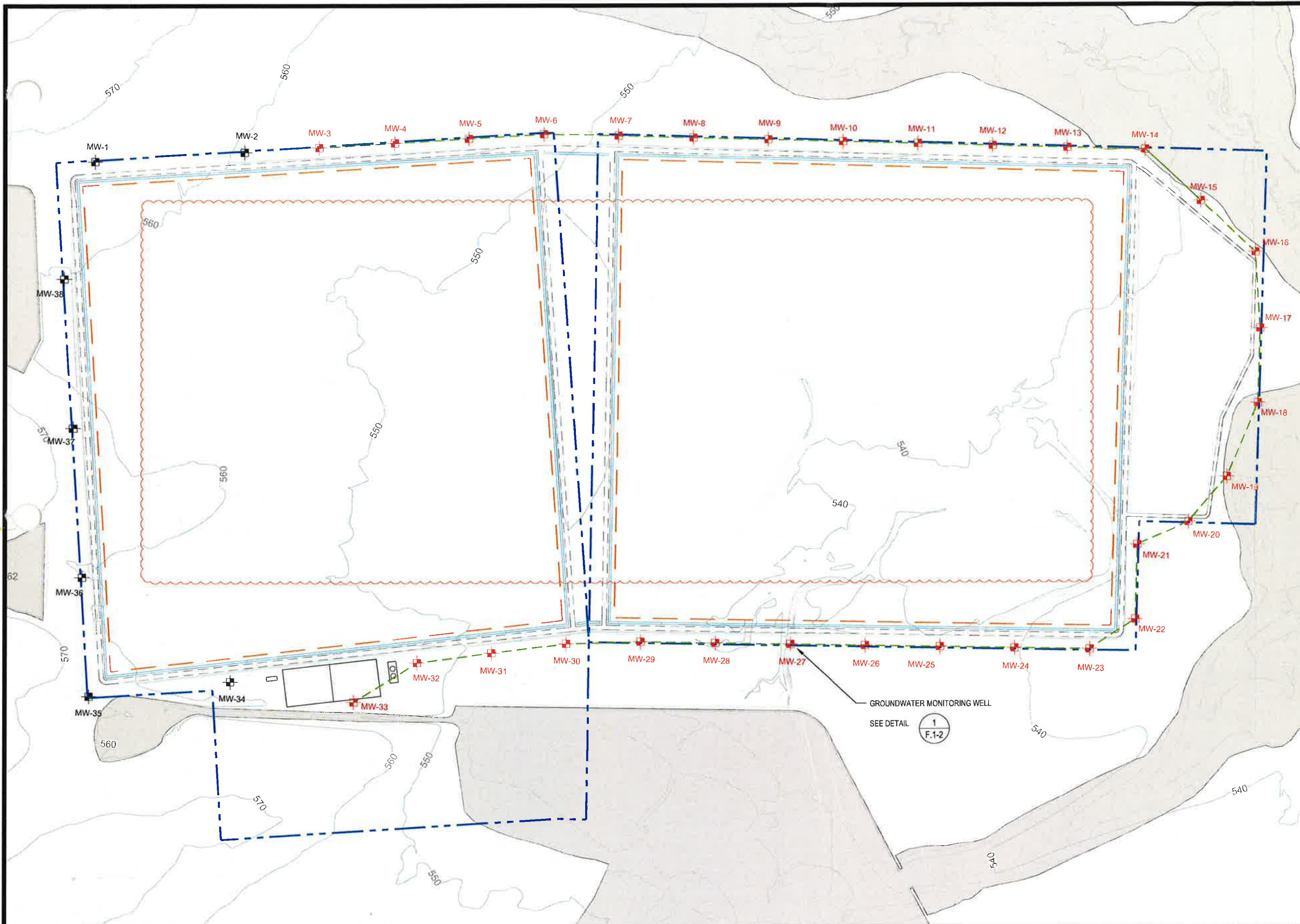

LEGEND

- PERMIT BOUNDARY
- WASTE UNIT BOUNDARY
- PERIMETER DITCH
- PERIMETER ACCESS ROAD
- MW-1 GROUNDWATER MONITORING WELL (UPGRADIENT)
- GW-10 GROUNDWATER MONITORING WELL (DOWNGRADIENT)
- CLOMR 100-YEAR FLOODPLAIN
- POINT OF COMPLIANCE (P.O.C.)

NOTES

1. EXISTING CONTOURS DEVELOPED FROM SITE AERIAL TOPOGRAPHIC SURVEY BY DALLAS AERIAL SURVEYS ON FEBRUARY 15, 2010.
2. FOR CLARITY, NOT ALL SITE FEATURES MAY BE SHOWN.
3. THE NEED FOR FLEXIBILITY TO ACCOMMODATE ADJUSTMENTS AND MODIFICATIONS IS ANTICIPATED CONSIDERING THE SIZE, COMPLEXITY, AND LIFE OF THE PROJECT.
4. MW-3 TO MW-33 ARE DOWNGRADIENT ALONG P.O.C.
5. MW-1, MW-2, AND MW-34 TO MW-38 ARE UPGRADIENT.

REV. NO.	DATE	DESCRIPTION
1	9/2015	NOD 1

CBI CB&I Environmental & Infrastructure, Inc.
 TBPE FIRM F-5650

CB&I Environmental and Infrastructure, Inc. has prepared this document for a specific project or purpose. All information contained within this document is copyrighted and remains the property of CB&I Environmental and Infrastructure, Inc. This document may not be used or copied, in part or in whole, for any reason without expressed written consent by CB&I Environmental and Infrastructure, Inc.

STATE OF TEXAS
 REGISTERED PROFESSIONAL ENGINEER
 MICHAEL W. ODEN
 67165

THIS DOCUMENT IS RELEASED FOR THE PURPOSE OF PERMITTING UNDER THE AUTHORITY OF MICHAEL W. ODEN, P.E. 67165.

**PESCADITO ENVIRONMENTAL RESOURCE CENTER
 WEBB COUNTY, TEXAS
 MSW 2374**

GROUNDWATER MONITORING SYSTEM PLAN

PROJ. NO.: 148866	DATE: APRIL 2015
DESIGNED BY: -	DRAWING NO. III
DRAWN BY: MTE	F.1-1
CHECKED BY: RDS	1 OF 2 SHEETS
APPROVED BY: MWQ	